

Solid Surface Worktop with Undermount Basin 1286 x 465mm Double Curve Nero Marquina 5905NM

Technical Drawings

All dimensions in mm. Please check dimensions prior to installation.

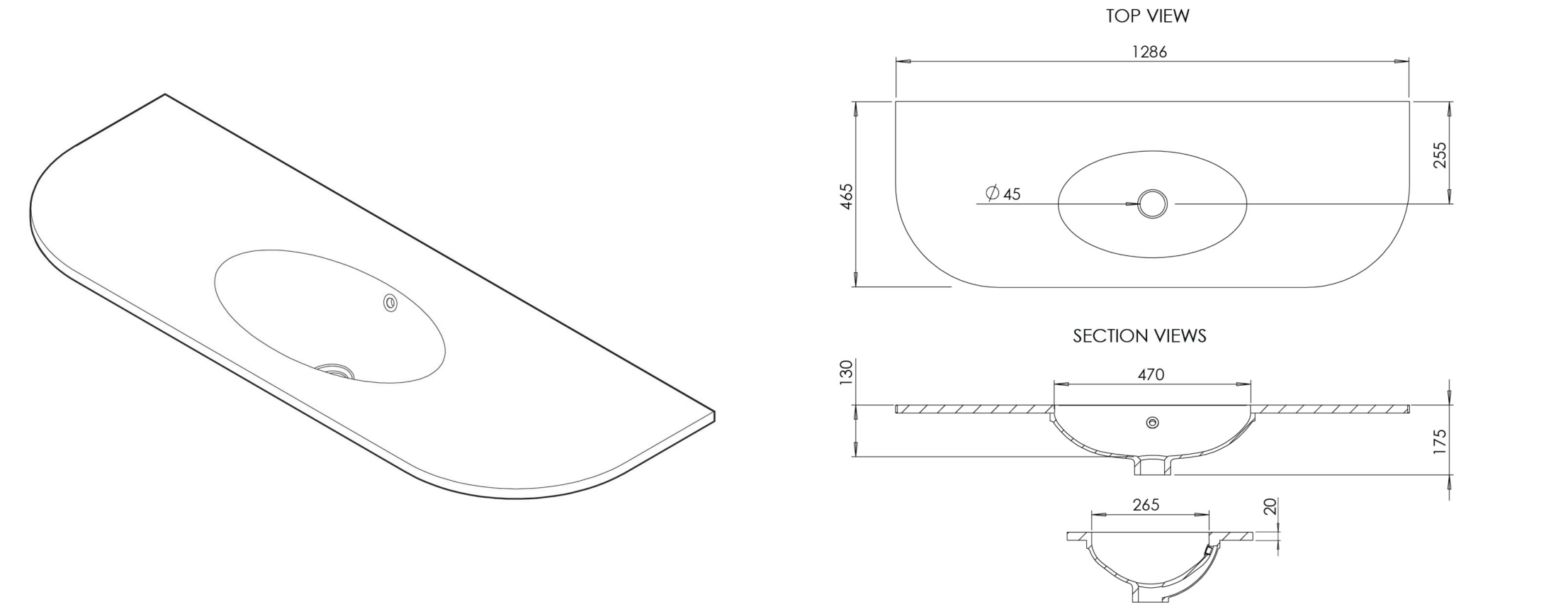

Technical Details

Dimensions (WxDxH):	1286 x 465 x 175mm
Basin Type:	Worktop with Undermount Basin
Basin Construction Material:	Ceramic
Basin Interior:	White Gloss
Basin Exterior:	White Gloss
Worktop:	Natural Agglomerate Marble Nero Marquina
Number of Bowls:	1
Number of Tap Holes:	0
Overflow Type:	Integrated Overflow
Supplied Overflow Ring Colour:	Chrome
Interchangeable Overflow Ring Type:	Type 4
Waste Hole Diameter:	45 mm
Guarantee Period:	5 Years
Dimensional Tolerance:	Please note that all dimensions have a tolerance of +/- 5mm.

In The Box:

Solid Surface Worktop with Undermount Basin 1286 x 465mm Double Curve Nero Marquina

Contact