

PRODUCT	ADELFA COMPLIMENT UNIT (33KG)
UNIT SIZE	1000w x 460d x 325h

FITTING ADVICE

- The shaded areas indicate the clear voids for the running of services.
- This unit is very heavy. A secure wall fixing is required.
- To aid installation, it is recommended to remove the drawers to give full access and to avoid damage.
- Recommended height from floor to top of vanity unit carcass is 810mm.
- All wall to carcass and wall to basin joints should be sealed with silicone.
- All dimensions are in mm

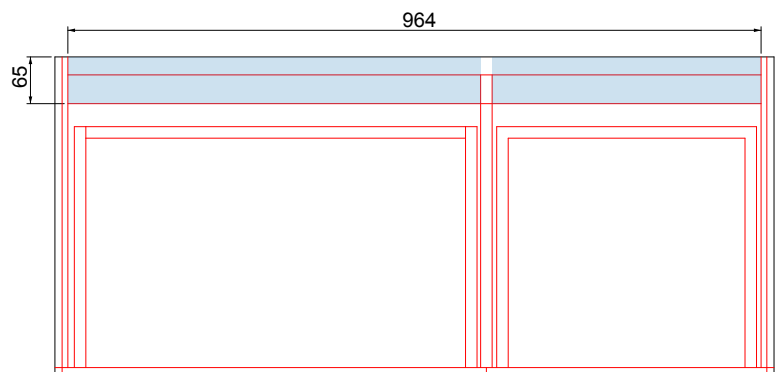
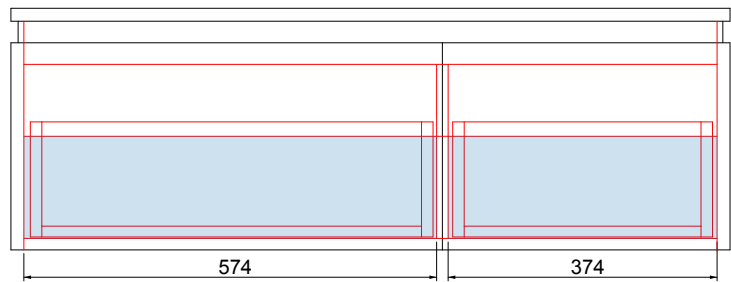
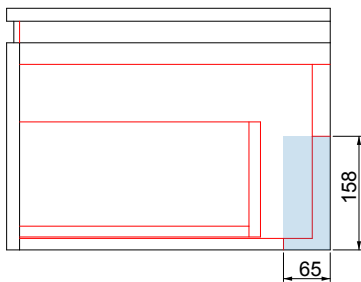

To aid installation, it is recommended to remove the drawers to give full access and to avoid damage.

1. Fit the vanity carcass through the hanging bracket using suitable fixings for the substrate.
2. Fix through the upper bar locations for additional support as suggested below.
3. Silicone around the rear of the unit and worktop at wall abutment.
4. Re-fit drawers.

