

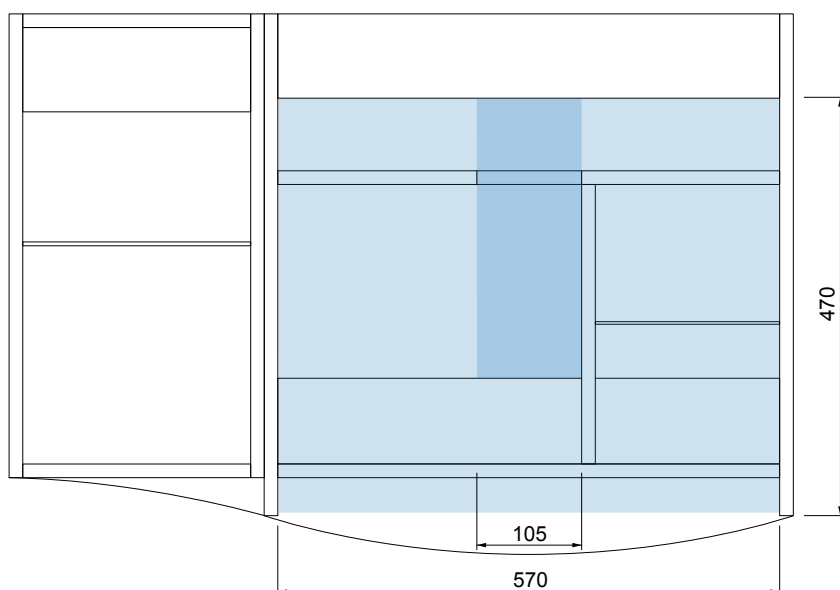

PRODUCT	CASELLA 1040 RH VANITY UNIT (46KG)
UNIT SIZE	1030w x 500d x 550h
BASIN OPT1	MERA CAST - 9248 (12KG)
BASIN SIZE	1040w x 520d x 15h
BASIN OPT2	ORTA GLASS - 9217 (19KG)
BASIN SIZE	1040w x 520d x 15h

FITTING ADVICE

- The shaded areas indicate the clear voids for the running of services.
- This unit is very heavy. It is made from a central unit and a LH compliment unit. A secure wall fixing is required.
- To aid installation, it is recommended to remove the doors to give full access and to avoid damage.
- Recommended height from floor to top of vanity unit carcass is 810mm.
- All wall to carcass and wall to basin joints should be sealed with silicone.
- All dimensions are in mm

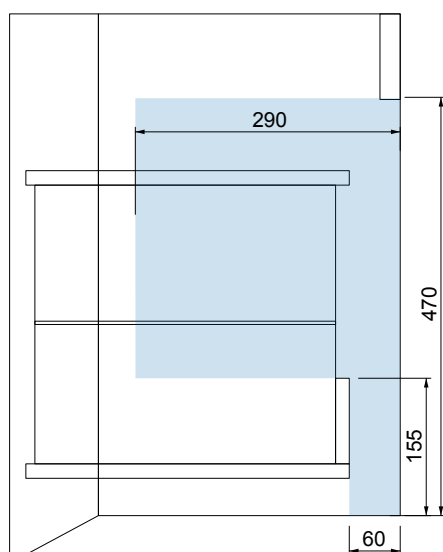

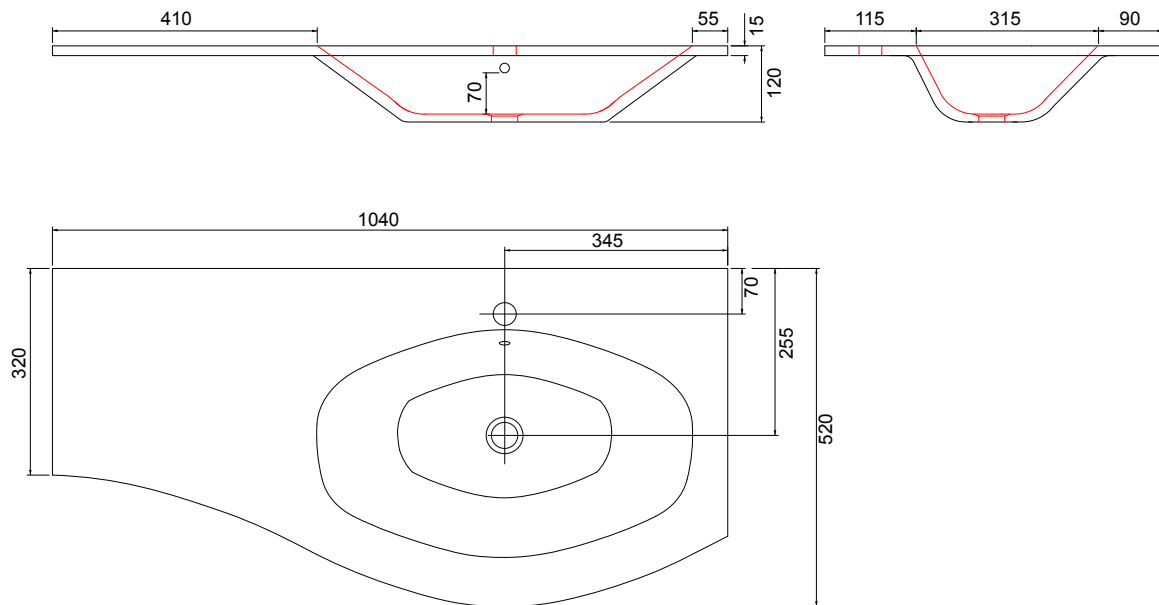

CAST MARBLE BASINS

The core ingredient of our Cast Marble basins is Dolomite Marble which is formed through volcanic action. The rock is milled and purified before being mixed with polymer resin formed into the required shape and then coated with a resin and quartz mixed gel coat to save its pigment and smooth finish.

The result is an extremely durable and easy to maintain product coupled with the benefit of constant sizing and smooth finishing that cannot be matched by traditional ceramics. Scratches are also repairable making this a more forgiving option. Cast basins have a sharp and ultra modern structured appeal to them.



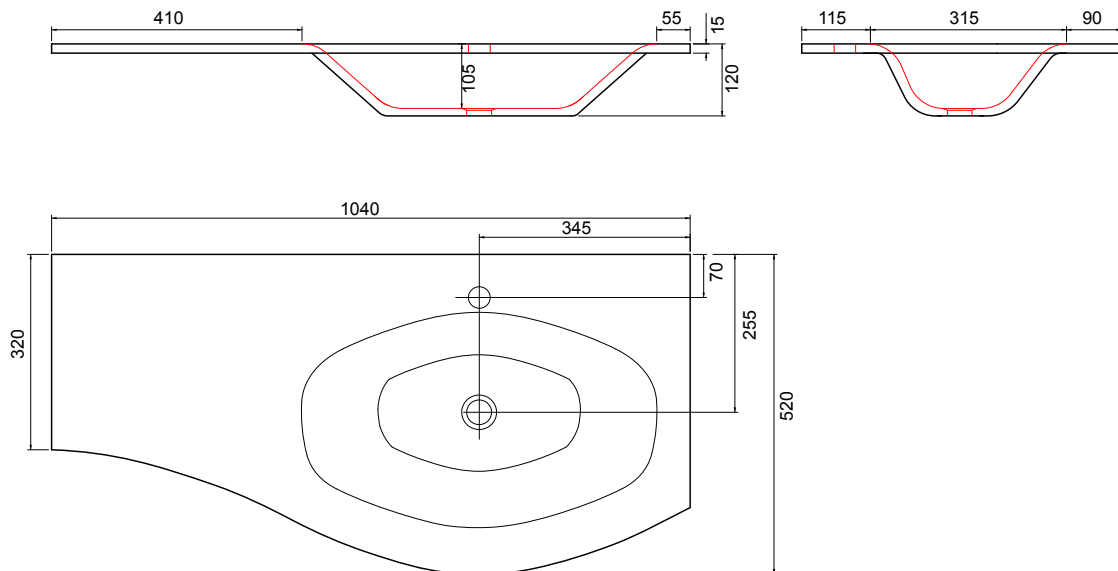

GLASS BASINS

Glass basins are perfectly formed and benefit from being naturally anti-bacterial. They are a durable alternative to standard basins and are comparable in strength. With no overflow on these basins, they have a minimal clean sleek look.

There are two points which could cause fracture or breakage to glass basins. Firstly, if there is a thermal shock from a sudden temperature change of more than 20°C, ambient room temperature should be maintained around 16 - 23°C. Secondly, you must avoid pouring hot water over 48°C into a glass basin. The waste assembly must be hand-tightened only.



To aid installation, it is recommended to remove the doors and glass shelves to give full access and to avoid damage.

1. Fit the vanity carcass through the hanging bracket using suitable fixings for the substrate.
2. Fix through the upper bar locations for additional support as suggested below.
3. Silicone around the top of the unit and place basin.
4. Silicone around the rear of the unit and basin at wall abutment.
5. Re-fit doors.

